

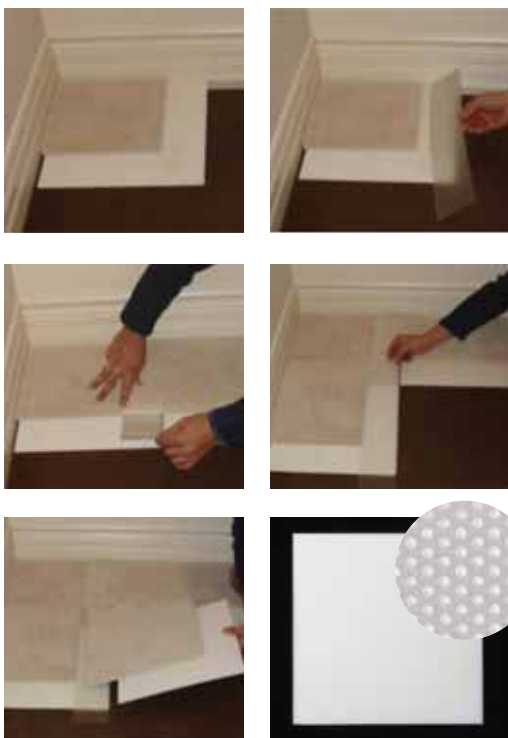

The installation of Senator One-Step Carpet Tiles is accomplished in a “one-step” process as the pre-attached pieces (surface module and hook substrate) are installed simultaneously – making installation quick, clean and easy. The simplicity and flexibility of the installation method makes Senator One-Step™ with TacFast an excellent product line for the Commercial Retail Market. (Below images are a guide for installation).



Senator One-Step Tile

Senator One-Step™ Carpet Tiles with TacFast backing, create a free-floating modular floor that can be installed over any sub floor without any attachment to that sub floor.

Specifications

Construction	Needle Felt- Plush Velour
Fiber Content	50% Polypropylene, 20% Nylon, 30% Polyester
Pile Weight	28 oz. per s/y
Total Weight	359 oz. per s/y
Backing	Bitumen or TacFast with Plates
Thickness	.62"
Tile size	19.69" x 19.69"
1 carton	10 tiles or 27.09 sq.ft.
Wear Warranty	7 years on flat surfaces
Electrostatic Propensity	Permanently anti-static
Flammability Rating	(See below)
Radiant Panel Test - ASTM E648	Passes federal flamm. standard (Class-1)
Pill Test - ASTM D28259	Pass
Hot Metal Nut Test - BS4790/BS5287	Pass
LEED	May contribute towards points, inquire

